



14 Ouseland Road

, Bedford, MK40 4NX

Price Guide £360,000

Floor Plan

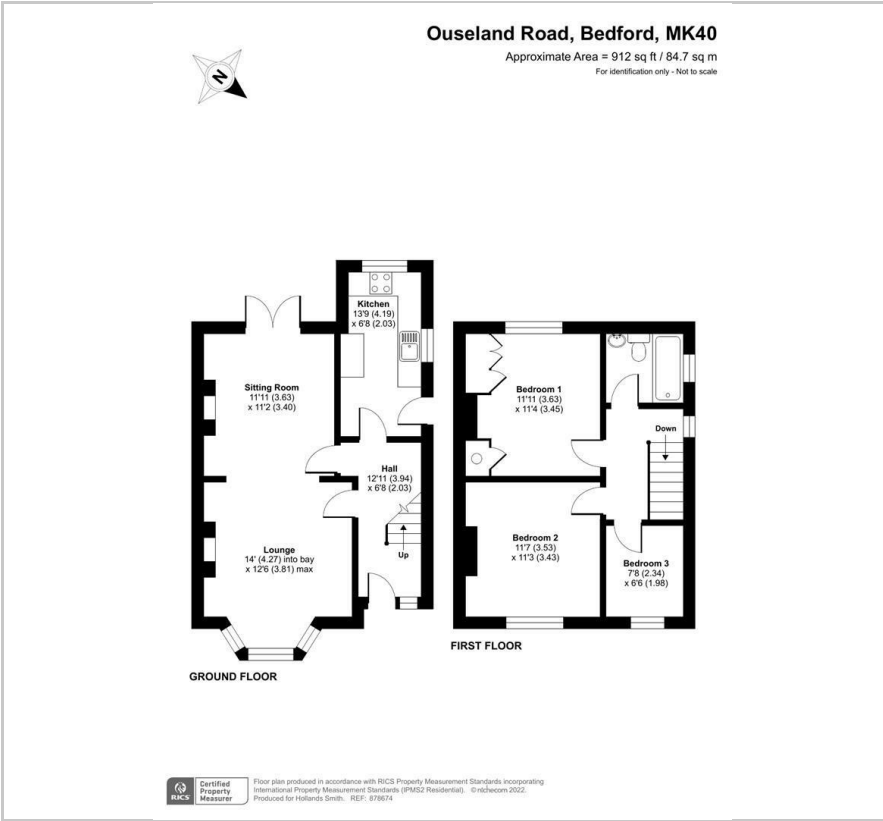

Area Map



Energy Efficiency Graph

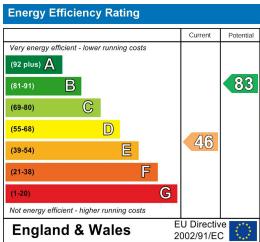

Viewing

Please contact our Bedford Office on 01234 216612 if you wish to arrange a viewing appointment for this property or require further information.



Quietly situated, this bay fronted detached home occupies a generous, west facing garden plot. The accommodation features three bedrooms, an open plan living room with French doors to the rear garden, kitchen and first floor bathroom. There is gas radiator heating and all of the windows are uPVC double glazed. The plot size provides significant potential for the existing footprint to be developed without compromising the garden space. Located in the heart of Queens Park, a range of facilities and independent shops are close at hand including Allen Park and attractive riverside walks. The property is within a mile of Bedford's town centre and has easy access to the main line rail station (St Pancras 40 mins). EER: This established detached home is comfortably proportioned and is an ideal opportunity on which the new owner can put their own stamp. The garden plot is a particular feature of the property having some width to either side of the house, is walled all around and extends to approximately 80' in depth to the rear.



163 Castle Road, MK40 3RT

Tel: 01234 216612

www.hollandsmith.co.uk

These particulars are believed to be accurate but are not guaranteed to be so. They are intended only as a general guide and cannot be constructed as any form of contract, warranty or offer. No apparatus, equipment, fittings or services have been tested and so we cannot verify that they are in working order. The details are issued on the strict understanding that any negotiations in respect of the property are conducted through Hollands Smith Estate Agents and Valuers.